





COMPONENTS	TOOLS REQUIRED	HARDWARE
<ul style="list-style-type: none"> • Countertop • Sink basin(s) • Backsplash 	<ul style="list-style-type: none"> • Permanent marker • Caulking gun + Silicone 	<div style="display: flex; flex-wrap: wrap;"> <div style="width: 50%;"> <p>A</p>  <p>Bolts (4)</p> </div> <div style="width: 50%;"> <p>B</p>  <p>Wing nuts (4)</p> </div> <div style="width: 50%;"> <p>C</p>  <p>Washers (4)</p> </div> <div style="width: 50%;"> <p>D</p>  <p>Undermount clips (4)</p> </div> </div>



STEP 1 - PLACE & TRACE

Place the sink basin on the underside of the countertop, face down. Make sure it is centered over the opening in the countertop. Draw two guiding lines at the topmost and bottommost positions of the sink, intersecting both the countertop and the sink for positioning purposes.

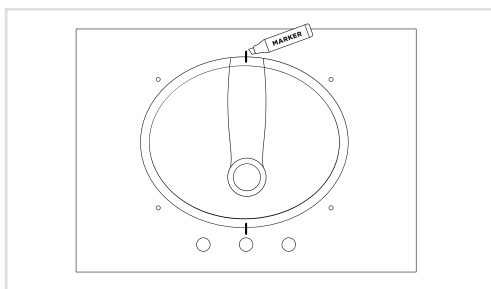
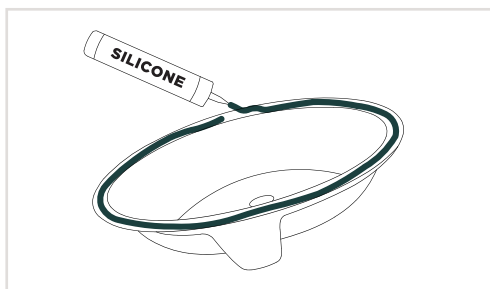

STEP 2 - PREPARE SINK BASIN

Using a caulking gun, apply an ample amount of silicone glue of your choice to the top side of the sink basin edge.

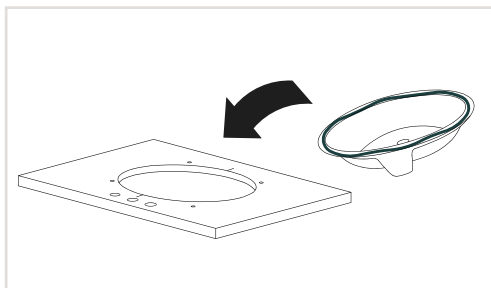

STEP 3 - FLIP & SET IN PLACE

Carefully flip the basin over and place it so the guiding lines matches up between the sink and the countertop.

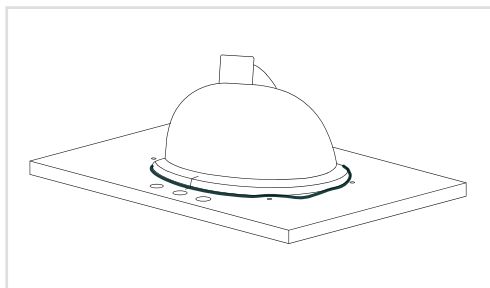

STEP 4 - DRY & SET

Press down on the sink basin to seal the silicone. Remove any excessive silicone on the outer edge. Follow the recommended drying time found on your silicone product, typically 12 to 24 hours.

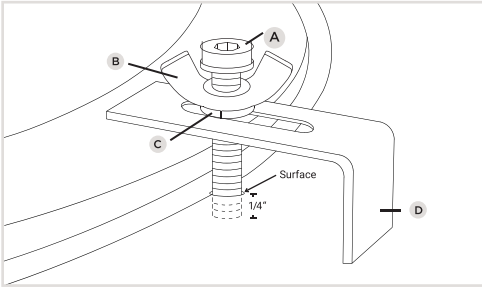

STEP 5 - ATTACH UNDERMOUNT CLIPS

While the glue is drying, tighten Bolt (A) into Wing Nut (B) sliding through Washer (C) and guide them through the Undermount Clip (D) opening into the threaded bolt holes in the countertop. Leveraging the Wing Nut, hand-tighten the Bolt tightly into the countertop surface.

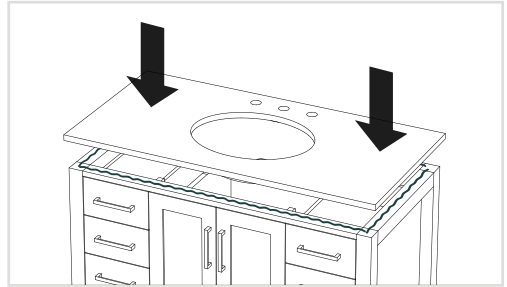

STEP 6 - SET COUNTERTOP ONTO YOUR CABINET

Apply silicone glue to the upper edge of your cabinet where it would meet the countertop. After the silicone glue has dried, flip the countertop and set on top of the vanity. Press down against the edges.

*Note: Cabinet is not included with this product. This guide is intended for installation of our countertop with your cabinet of choice.

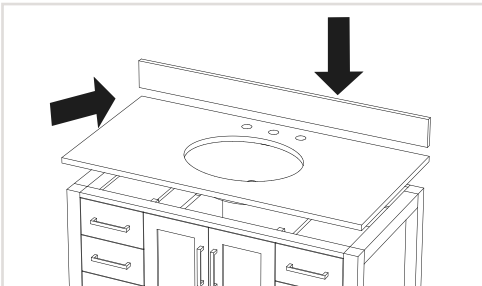

STEP 7 - SET BACKSPLASH

After the countertop is in place, apply silicone glue to the unpolished (roughed) bottom and back sides of the backsplash. Press down against the countertop and backward against the wall to set the backsplash in place. Remove any excessive silicone.